



**GRAY  
TOOLS  
100 YEARS**



**Professional Tools Specials Winter 2014**

**Offers Expire: April 30, 2014**

## Pro, GT & XL Series Toolbox Features:

- Single bit keys provide up to 50 different locking combinations for maximum security.
- Heavy gauge construction.

- Heavy-duty casters with cross tread brakes - 5" x 2" -1,250 lb. load rating.
- Automotive quality powered coat finish for superior scratch and chemical resistance.



### 97120 12 Drawer Deep Top Chest - PRO Series

- 26 $\frac{1}{8}$ " x 17 $\frac{1}{2}$ " x 21"
- Capacity: 7,056 cu. in.

List \$619.11

**\$363<sup>95</sup>**



### 90119 9 Drawer Top Chest - GT Series

- Includes ball bearing slides on full width drawers
- 40 $\frac{5}{16}$ " x 17 $\frac{1}{2}$ " x 21"
- Capacity: 9,638 cu. in.

List \$1,032.93

**\$619<sup>95</sup>**



### 92110 10 Drawer Top Chest - XL Series

- Includes ball bearing slides on full width drawers
- Includes corrosion inhibiting drawer liners
- 34 $\frac{5}{8}$ " x 17 $\frac{1}{2}$ " x 21"
- Capacity: 9,098 cu. in.

List \$1,156.85

**\$694<sup>95</sup>**



### 97211 11 Drawer Roller Cabinet - PRO Series

- 26 $\frac{1}{2}$ " x 18" x 42 $\frac{1}{2}$ "
- Capacity: 12,276 cu. in.

List \$843.76

**\$429<sup>95</sup>**



### 90215 15 Drawer Roller Cabinet - GT Series

- Includes ball bearing slides on full width drawers
- 40 $\frac{1}{16}$ " x 18" x 42 $\frac{1}{2}$ "
- Capacity: 14,965 cu. in.

List \$1,619.30

**\$928<sup>95</sup>**



### 92208 8 Drawer Roller Cabinet - XL Series

- Includes ball bearing slides
- Includes corrosion inhibiting drawer liners
- 35" x 18" x 42 $\frac{1}{2}$ "
- Capacity: 14,720 cu. in.

List \$1,858.60

**\$1,114<sup>95</sup>**



### 9118 18" Cantilever Tool Box

- 18" x 10 $\frac{1}{8}$ " x 13 $\frac{1}{4}$ "
- Capacity: 1,530 cu. in.

List \$194.11

**\$103<sup>95</sup>**



### 9120 20" Heavy Duty Tool Box

- 20" x 8 $\frac{1}{2}$ " x 9 $\frac{1}{2}$ "
- Capacity: 1,627 cu. in.

List \$72.73

**\$42<sup>95</sup>**



### 9104 24" Tool Box with Side Handles

- 24 $\frac{1}{4}$ " x 9 $\frac{1}{2}$ " x 9 $\frac{1}{2}$ "
- Capacity: 1,866 cu. in.

List \$95.30

**\$57<sup>95</sup>**

## Marquis Series Toolbox Features:

- Safety latch drawer system prevents drawers from accidentally opening.
- Heavy-duty roller bearing slides allow heavily loaded drawers to open and close with ease.
- Industrial black wrinkle finish offers superior scratch and fade resistance.
- Pre-cut oil and moisture resistant drawer liners included.



99806SB

### 6 Drawer Top Chest - Marquis Series

- Includes ball bearing slides and safety latches
- Drawer liners included
- 26" x 16" x 19"
- Capacity: 5,474 cu. in.
- List \$609.12

**\$364<sup>95</sup>**



99808SB

### 8 Drawer Top Chest - Marquis Series

- Includes ball bearing slides and safety latches
- 26" x 16" x 19<sup>1</sup>/<sub>4</sub>"
- Capacity: 5,453 cu. in.
- List \$719.05

**\$431<sup>95</sup>**



99107SB

### 7 Drawer Top Chest - Marquis Series

- Includes ball bearing slides and safety latches
- 41<sup>1</sup>/<sub>2</sub>" x 18<sup>1</sup>/<sub>2</sub>" x 23<sup>3</sup>/<sub>4</sub>"
- Capacity: 12,276 cu. in.
- List \$1,548.68

**\$929<sup>95</sup>**



99509SB

### 9 Drawer Roller Cabinet - Marquis Series

- Includes ball bearing slides and safety latches
- 26<sup>1</sup>/<sub>2</sub>" x 18" x 39<sup>1</sup>/<sub>8</sub>"
- Capacity: 9,157 cu. in.
- List \$1,040.99

**\$624<sup>95</sup>**



99210SB

### 10 Drawer Roller Cabinet - Marquis Series

- Includes ball bearing slides and safety latches
- 42" x 19" x 40"
- Capacity: 13,901 cu. in.
- List \$2,495.61

**\$1,497<sup>95</sup>**



97403B

### 3 Shelf Utility Cart

- 33<sup>1</sup>/<sub>2</sub>" x 19" x 39<sup>3</sup>/<sub>8</sub>"
- List \$291.43

**\$174<sup>95</sup>**



97505BL

### 5 Drawer Drop Front Truck Box

- 26<sup>1</sup>/<sub>4</sub>" x 17<sup>1</sup>/<sub>2</sub>" x 22"
- Capacity: 6,500 cu. in.
- List \$757.39

**\$454<sup>95</sup>**



59706A

**6 Piece Metric Multigear™ Ratcheting Wrench Double Box Fixed Head**

- 8 x 9mm, 10 x 11mm, 12 x 13mm, 14 x 15mm, 16 x 18mm, 17 x 19mm
  - Stainless steel construction
- List \$239.98  
**\$154<sup>95</sup>**



59804A

**4 Piece SAE Multigear™ Ratcheting Wrench Double Box Flex Head**

- 5/16" x 3/8", 7/16" x 1/2", 9/16" x 5/8", 11/16" x 3/4"
  - Stainless steel construction
- List \$194.62  
**\$124<sup>95</sup>**



64811

**11 Piece Metric Stubby Combination Wrench Set**

- 9 - 19mm
  - 12 Pt., Mirror chrome finish
  - Includes gripper organizer
- List \$301.89  
**\$194<sup>95</sup>**



63809

**9 Piece SAE Stubby Combination Wrench Set**

- 1/4" - 3/4"
  - 12 Pt., Mirror chrome finish
  - Includes gripper organizer
- List \$222.08  
**\$126<sup>95</sup>**



MB6

**6 Piece Metric Box End Wrench Set**

- 8mm x 9mm to 20mm x 22mm
  - 12 Pt., Mirror chrome finish
  - With red gripper organizer.
- List \$184.75  
**\$99<sup>95</sup>**



DO12

**6 Piece SAE Box End Wrench Set**

- 3/8" x 7/16" - 15/16" x 1"
  - 12 Pt., Mirror chrome finish
  - With red gripper organizer
- List \$239.54  
**\$139<sup>95</sup>**



MC214

**14 Piece Metric Combination Wrench Set**

- 7mm - 32mm
  - 12 Pt., Mirror chrome finish
  - Includes gripper organizer
- List \$683.77  
**\$351<sup>95</sup>**



TU14S

**14 Piece SAE Combination Wrench Set**

- 3/8" - 1 1/4"
  - 12 Pt., Mirror chrome finish
  - Includes gripper organizer
- List \$672.39  
**\$364<sup>95</sup>**



### Structural Wrenches Offset Head

	Hex Size	Length	Head Width	Head Thickness	List	
906	15/16"	14 1/2"	2 9/32"	7/16"	\$52.14	<b>\$33<sup>95</sup></b>
907	1 1/16"	16 3/4"	2 9/32"	7/16"	\$60.14	<b>\$34<sup>95</sup></b>
907A	1 1/8"	16 3/4"	2 1/2"	1 9/32"	\$63.72	<b>\$39<sup>95</sup></b>
908	1 1/4"	17 3/4"	2 1/2"	1 9/32"	\$75.94	<b>\$48<sup>95</sup></b>



### Heavy Duty Adjustable Wrenches

• Matte finish

	Length	Maximum Opening	List	
65304	4"	.55"	\$31.67	<b>\$19<sup>95</sup></b>
65306A	6"	1.00"	\$33.01	<b>\$21<sup>95</sup></b>
65308A	8"	1.08"	\$34.50	<b>\$22<sup>95</sup></b>
65310A	10"	1.35"	\$44.13	<b>\$28<sup>95</sup></b>
65312A	12"	1.50"	\$63.54	<b>\$39<sup>95</sup></b>



### TM750A

#### Torque Multiplier

- 750 ft. lbs.
- Input drive: 1/2" F
- Output drive: 3/4" M
- Torque ratio: 3.3:1
- 8.6" long

List \$1,099.43

**\$746<sup>95</sup>**



### TM2200

#### Torque Multiplier

- 2,200 ft. lbs.
- Input drive: 1/2" F
- Output drive: 1" M
- Torque ratio: 13.6:1
- 19.6" long
- In custom molded plastic case

List \$4,133.46

**\$2,804<sup>95</sup>**

## Industrial Quality Hex Keys

- Made of premium S<sub>2</sub> steel for superior durability and corrosion resistance.
- Up to 33% more torque than ordinary keys
- Size and part number is permanently etched on each key making retrieval faster and more convenient (1/8" & 3mm and larger only).



### 68723

#### 22 Piece Long Arm S<sub>2</sub> Hex Key Wrench Set

- 13 piece SAE: 0.05" - 3/8"
- 9 piece Metric: 1.5mm - 10mm
- Made of premium grade S<sub>2</sub> steel
- 33% greater torque than ordinary hex keys

List \$28.20

**\$14<sup>95</sup>**



### 68722

#### 22 Piece Long Arm Ball S<sub>2</sub> Hex Key Wrench Set

- 13 Pc. SAE: 0.05" - 3/8"
- 9 Pc. Metric: 1.5mm - 10mm
- Made of premium grade S<sub>2</sub> steel
- 33% greater torque than ordinary hex keys

List \$46.45

**\$27<sup>95</sup>**



### 69937

#### 7 Piece Metric Short Folding Hex Key Set

- Sizes: 1.5, 2, 2.5, 3, 4, 5, 6mm
- Made of premium grade S<sub>2</sub> steel

List \$7.75

**\$4<sup>95</sup>**



### 69958

#### 9 Piece SAE Short Folding Hex Key Set

- Sizes: .050", 1/16", 5/64", 3/32", 7/64", 1/8", 9/64", 5/32", 3/16"
- Made of premium grade S<sub>2</sub> steel

List \$7.70

**\$4<sup>95</sup>**



### 69927

#### 7 Piece Folding Torx<sup>®</sup> Hex Key Set

- Sizes: T10, T15, T20, T25, T27, T30, T40
- Made of premium grade S<sub>2</sub> steel

List \$18.47

**\$11<sup>95</sup>**

# What makes Gray sockets and ratchets unique?



29015

## 15 Piece 3/8" Drive Metric Socket & Attachment Set

- Reg: 9, 10, 11, 12, 13, 14, 15, 16, 17, 18, 19mm
- 6 Pt. Chrome sockets
- Ratchet
- U-Joint
- 3" Extension
- 6" Extension

List \$268.22

**\$172<sup>95</sup>**



25126

## 26 Piece 3/8" Drive SAE Socket & Attachment Set

- Reg: 3/8" - 1"
- Deep: 3/8" - 1"
- 12 Pt. Chrome sockets
- Ratchet
- U-Joint
- 3" Extension
- 6" Extension

List \$455.01

**\$273<sup>95</sup>**



15110

## 10 Piece 1/4" Drive SAE Socket Set

- 3/16" - 9/16"
- 12 Pt., Mirror chrome finish with socket bar

List \$83.47

**\$53<sup>95</sup>**



19212

## 12 Piece 1/4" Drive Deep Metric Socket Set

- 4 - 14mm
- 6 Pt., Mirror chrome finish with socket bar

List \$152.90

**\$98<sup>95</sup>**



25113

## 13 Piece 3/8" Drive SAE Socket Set

- 1/4" - 1"
- 12 Pt., Mirror chrome finish with socket bar

List \$131.55

**\$84<sup>95</sup>**



29314

## 14 Piece 3/8" Drive Deep Metric Socket Set

- 6 - 19mm
- 12 Pt., Mirror chrome finish with socket bar

List \$172.35

**\$109<sup>95</sup>**



35015

## 15 Piece 1/2" Drive SAE Socket Set

- 3/8" - 1 1/4"
- 6 Pt., Mirror chrome finish with socket bar

List \$229.01

**\$121<sup>95</sup>**



39119

## 19 Piece 1/2" Drive Metric Socket Set

- 10 - 28mm
- 12 Pt., Mirror chrome finish with socket bars

List \$276.38

**\$177<sup>95</sup>**



36815

## 15 Piece 1/2" Drive Metric Impact U-Joint Set

- 10 - 24mm
- 6 Pt., Industrial black finish with socket bar

List \$491.65

**\$316<sup>95</sup>**



24510

## 10 Piece Female Torx® Socket Set

- Contains: 1/4" Drive: E4, E5, E6, E7, E8
- 3/8" Drive: E10, E12, E14, E16
- 1/2" Drive: E18

List \$103.24

**\$57<sup>95</sup>**

It is the superior corrosion resistance as a result of Gray's proprietary in-house plating process. In recent salt spray tests conducted by an independent laboratory the Gray socket showed the least amount of corrosion damage compared to the other competing products. In addition to superior corrosion resistance Gray chrome sockets also feature a distinct brilliant jewellery like finish. Gray sockets and accessories are backed by a Lifetime Warranty, making them an investment for life.



### Reversible Ratchets Chrome Finish

	Drive	N° of Teeth	Length	List	
V2536	1/4"	36	5"	\$55.43	<b>\$34<sup>95</sup></b>
T9040	3/8"	40	7.5"	\$59.54	<b>\$38<sup>95</sup></b>
8740	1/2"	40	10"	\$82.50	<b>\$53<sup>95</sup></b>
8740L	1/2"	40	15"	\$87.79	<b>\$56<sup>95</sup></b>



### T83 3/8" Drive Flex Handle Ratchet

- 11<sup>3</sup>/<sub>8</sub>" long
  - 45 Tooth
  - Chrome finish
  - Quick release button
- List \$98.37  
**\$63<sup>95</sup>**



### 8799F 1/2" Drive Flex Handle Ratchet

- 14<sup>1</sup>/<sub>2</sub>" long
  - 40 Tooth
  - Chrome finish
  - Quick release button
- List \$160.24  
**\$91<sup>95</sup>**



### 72250 3/8" Drive Micro-Adjustable Torque Wrench

- Micrometer adjustable: 50 - 250 in. lbs
- Length 10"
- Includes plastic carrying case

List \$376.70  
**\$247<sup>95</sup>**



### 73250 1/2" Drive Heavy Duty Torque Wrench

- Micrometer adjustable: 25 - 250 ft. lb.
- Length: 21<sup>3</sup>/<sub>4</sub>"
- Includes plastic carrying case

List \$427.96  
**\$262<sup>95</sup>**



### MFR600HD 3/4" Drive Heavy Duty Ratchet Head Torque Wrench

- Micrometer adjustable: 100 - 600 ft. lbs.
- Length: 43"
- Includes plastic carrying case

List \$1,255.04  
**\$591<sup>95</sup>**

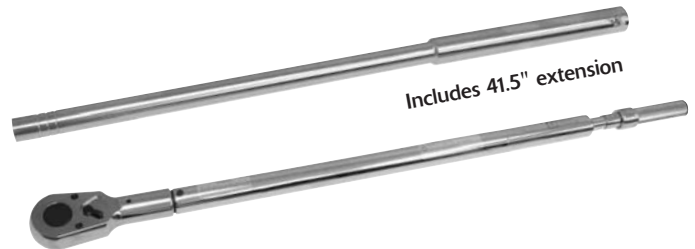

### MFR1000HD 1" Drive Micro-Adjustable Ratchet Head Torque Wrench

- Micrometer adjustable: 200 - 1,000 ft. lb.
- Adjustable in 5 ft. lb. increments
- 30 tooth design
- Maximum length (with extension): 71"
- Includes metal carrying case

List \$2,195.98  
**\$1,411<sup>95</sup>**



### T9 3/8" Drive Speeder

- 16<sup>1</sup>/<sub>4</sub>" long
- Chrome finish

List \$33.76  
**\$19<sup>95</sup>**



### 686 1/2" Drive Speeder

- 19<sup>1</sup>/<sub>4</sub>" long
- Chrome finish

List \$56.88  
**\$29<sup>95</sup>**



### 14003S 3 Piece 1/4" Drive Wobble Extension Set

- 2", 4", 6"
- Mirror chrome finish.
- Knurled grip.
- Comes in sturdy plastic tray.

List \$50.56  
**\$23<sup>95</sup>**



996

### 3 Jaw Puller

- Capacity: 1 ton
- Reach: 2 1/8"
- Maximum spread: 3 1/4"
- Completely assembled

List \$50.49  
**\$32<sup>95</sup>**



PO12

### Reversible 2/3 Jaw Puller

- Capacity: 7 ton
- Reach: 5"
- Maximum spread: 10 1/2"
- Completely assembled

List \$226.60  
**\$144<sup>95</sup>**



### Heavy Duty 3 Jaw Pullers

	Capacity (tons)	Reach	Spread	List	
P302T	2	3"	3/4" - 4 1/2"	\$124.55	<b>\$79<sup>95</sup></b>
P305T	5	5 1/2"	1" - 9 1/2"	\$225.43	<b>\$144<sup>95</sup></b>
P310T	10	9"	1 3/16" - 15"	\$486.52	<b>\$312<sup>95</sup></b>

• Unique fixed leg design allows for easy one person operation.

### Beam Clamps



	Rated Capacity (tons)	Flange Widths (in.)	List	
BC-1	1.0	2.95 - 8.25	\$131.24	<b>\$84<sup>95</sup></b>
BC-2	2.0	2.95 - 8.25	\$159.27	<b>\$102<sup>95</sup></b>
BC-3	3.0	2.95 - 12.0	\$256.95	<b>\$164<sup>95</sup></b>
BC-5	5.0	2.95 - 12.0	\$282.76	<b>\$181<sup>95</sup></b>

- Precision machined adjustment screw allows for quick, easy, and secure clamping to a variety of flange widths.
- Lightweight design and threaded adjustment screw allow for easy portability and installation.
- CE certified and compliant with ANSI B30.11 specifications.



### Plain Trolleys

	Rated Capacity (tons)	Standard I-Beam Min (in) Max (in)	List	
PT-0.5	0.5	4.92 x 2.95 x 0.22 9.84 x 4.92 x 0.30	\$175.27	<b>\$112<sup>95</sup></b>
PT-1	1.0	4.92 x 2.95 x 0.22 9.84 x 4.92 x 0.30	\$230.02	<b>\$147<sup>95</sup></b>
PT-2	2.0	7.09 x 3.94 x 0.24 13.78 x 5.91 x 0.35	\$383.76	<b>\$246<sup>95</sup></b>
PT-3	3.0	7.87 x 3.94 x 0.28 13.78 x 5.91 x 0.35	\$592.50	<b>\$379<sup>95</sup></b>

- Fully adjustable to suit most beam sizes. Easily and quickly, change the number of spacers to match the required width.
- Rugged steel frames.
- Integrated safety lugs offer additional protection from accidental falling of trolley.
- CE certified and compliant with ASME 30.11 specifications.



### Long Shank Eye Bolts

	Thread Size UNC-2A	Shank Length	Thread Length	Overall Length	Working Load Limit lbs	List	
BS08L	1/4-20	2"	1.5"	3 3/8"	650	\$5.28	<b>\$3<sup>95</sup></b>
BS10L	5/16-18	2.25"	1.5"	3 13/16"	1,200	\$5.48	<b>\$3<sup>95</sup></b>
BS12L	3/8-16	2.50"	1.5"	4 21/32"	1,550	\$7.05	<b>\$4<sup>95</sup></b>
BS16L	1/2-13	3.25"	2.0"	5 23/32"	2,600	\$8.85	<b>\$5<sup>95</sup></b>
BS20L	5/8-11	4"	3.0"	7"	5,200	\$11.13	<b>\$7<sup>95</sup></b>
BS24L	3/4-10	4.50"	3.0"	7 3/4"	7,200	\$13.76	<b>\$8<sup>95</sup></b>
BS08XL	1/4-20	4"	2.0"	5 3/8"	650	\$6.35	<b>\$4<sup>95</sup></b>
BS10XL	5/16-18	4.25"	2.5"	5 13/16"	1,200	\$6.57	<b>\$4<sup>95</sup></b>
BS12XL	3/8-16	4.50"	2.0"	6 1/32"	1,550	\$8.10	<b>\$5<sup>95</sup></b>
BS16XL	1/2-13	6"	3.0"	8 15/32"	2,600	\$8.85	<b>\$6<sup>95</sup></b>
BS20XL	5/8-11	6"	3.0"	9"	5,200	\$12.70	<b>\$8<sup>95</sup></b>
BS24XL	3/4-10	6"	3.0"	9 1/4"	7,200	\$15.72	<b>\$10<sup>95</sup></b>

- Forged
- Carbon steel
- Zinc plated
- Includes assembled galvanized hex nut





**C20LR**  
**20 Piece Punch & Chisel Set**

- Flat Chisel: 1/2", 5/8", 3/4", 7/8", 1"
- Long Taper Punch: 5/32", 3/16"
- Taper Punch: 3/32", 1/8", 3/16", 1/4"
- Pin Punch: 1/8", 5/32", 3/32", 3/16", 1/4", 5/16"
- Prick Punch: 3/8"
- Centre Punch: 3/8", 1/2"
- In solid maple organizer

List \$303.55  
**\$204<sup>95</sup>**

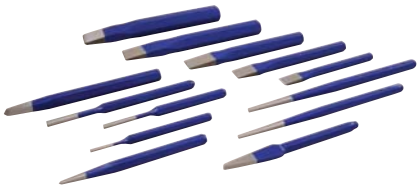

**C46LR**  
**13 Piece Punch & Chisel Set**

- Flat Chisel: 1/2", 5/8", 3/4", 7/8", 1"
- Cape Chisel: 1/4"
- Diamond Point Chisel: 1/4"
- Long Taper Punch: 5/32", 3/16"
- Pin Punch: 1/8", 3/16", 1/4"
- Centre Punch: 3/8"
- In canvas roll

List \$184.22  
**\$118<sup>95</sup>**



**C49LR**  
**5 Piece Punch & Chisel Set**

- Flat Chisel: 1/2", 3/4"
- Pin Punch: 1/8", 3/16"
- Centre Punch: 3/8"

List \$53.71  
**\$34<sup>95</sup>**



**S35P**  
**5 Piece Screw Extractor Set**

- Removes screw sizes:  
 1/8" to 1 1/16", 3mm - 18mm

List \$34.32  
**\$14<sup>95</sup>**



**SE70C**  
**7 Piece Straight Type Extractor Set**

- Screw, bolt or stud size:  
 1/4", 3/8", 7/16", 1/2", 5/8", 3/4", 7/8"

List \$111.04  
**\$54<sup>95</sup>**



**C5BDS**  
**5 Piece Brass Punch Set**

- Taper Punch: 1/4"
- Pin Punch: 3/8"
- Drift Punch: 3/8", 1/2", 3/4"
- In pouch

List \$96.10  
**\$61<sup>95</sup>**



**1/2" Drive Impact Hex Bit Insert Sets**

**IMD307KA**

- SAE
- 8 Pieces: 5/16", 3/8", 7/16", 1/2", 9/16", 5/8", 3/4"

List \$114.44

**\$73<sup>95</sup>**

**IMD308KM**

- Metric
- 9 Pieces: 8, 10, 12, 13, 14, 15, 17, 19mm

List \$123.60

**\$79<sup>95</sup>**

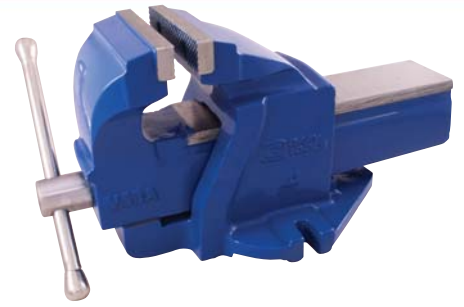

**Ductile Iron Bench Vises**

- Made of ductile iron which is lighter yet 3 times stronger than grey iron cast vises
- 60,000 PSI
- Serrated jaws offer a secure and strong hold
- Precision lead screw threads ensure maximum clamping strength

	Jaw width	List	
<b>VS3A</b>	4"	\$143.32	<b>\$92<sup>95</sup></b>
<b>VS4A</b>	4.5"	\$182.95	<b>\$117<sup>95</sup></b>
<b>VS5A</b>	5"	\$213.23	<b>\$137<sup>95</sup></b>
<b>VS6A</b>	6"	\$285.33	<b>\$183<sup>95</sup></b>
<b>VS8A</b>	8"	\$342.75	<b>\$219<sup>95</sup></b>



**IMD208K**

**6 Piece Impact Driver & Attachment Set**

- 3/8 sq. drive impact driver
- 5/16" hex bit adapter
- No. 2 & 3 Phillips®
- 5/16" & 3/8" Slotted 1 7/16" long

List \$97.64  
**\$49<sup>95</sup>**

# Grip-on® - the widest and most modern range of locking tools in the world.

Here are just a few reasons why Grip-on is a superior alternative to ordinary locking tools:

- Finished with an epoxy resin coating that is 10 times more corrosion resistant than nickel plating
- Tools feature a piano wire spring ensuring superior tool life and reliable opening and closing of tool
- A no pinch easy release lever eliminates painful accidental pinching of hands and fingers



## Locking Pliers with Curved Jaw

	Overall Length	Jaw Opening	List	
111-05	5"	1 1/8"	\$19.73	<b>\$12<sup>95</sup></b>
111-07F	7"	1 7/8"	\$23.39	<b>\$14<sup>95</sup></b>
111-10	10"	2 7/16"	\$25.50	<b>\$18<sup>95</sup></b>
111-12	12"	2 15/16"	\$37.42	<b>\$24<sup>95</sup></b>

- Narrow, large opening curved shaped jaws allow firm hold on all round shapes.

## GK-SETS

### 5 Piece Locking Pliers Set

Set Includes:

- 7" & 10" omnium grip locking plier
- 5" & 10" curved jaw locking plier
- 10" locking plier hose clamp

List \$138.75

**\$89<sup>95</sup>**

## Locking Pliers with Swivel Pads

	Overall Length	Jaw Opening	List	
224-06	6"	1 15/16"	\$30.62	<b>\$19<sup>95</sup></b>
224-12	12"	3 1/8"	\$50.59	<b>\$32<sup>95</sup></b>
224-14	14"	4 7/8"	\$54.44	<b>\$34<sup>95</sup></b>
224-18	18"	9 7/16"	\$73.98	<b>\$47<sup>95</sup></b>

- Knurled swivel pads allow non-slip no damage parallel clamping even on tapered surfaces.



## 45° Curved Needle Nose Pliers with Cutter

	Overall Length	Jaw Length	List	
B238B	6 1/4"	2"	\$35.57	<b>\$22<sup>95</sup></b>
B239B	7 7/8"	2 3/4"	\$44.96	<b>\$28<sup>95</sup></b>



Spring loaded

## Flush Cut Side Cutter

	Overall Length	Jaw Length	List	
B206	6"	3/4"	\$28.14	<b>\$18<sup>95</sup></b>
B207	7 1/2"	1"	\$33.32	<b>\$21<sup>95</sup></b>



## Crimping Pliers with Vinyl Grips

	Overall Length	Jaw Length	AWG	List	
B260B	5 3/4"	3/4"	25-15	\$47.21	<b>\$29<sup>95</sup></b>
B261B	7"	1 3/8"	25-5	\$61.60	<b>\$39<sup>95</sup></b>

- Ideal for crimping terminals and connectors for stranded cables with vinyl or rubber insulation
- Compact design with slim head for working in confined spaces
- Deep dies with conical side faces for proper use



## 83303

### 3 Piece High Leverage Plier Set

- 8 1/2" Combination plier
- 7 1/2" Diagonal plier
- 9" Long nose plier
- Includes vinyl zippered case

List \$79.44

**\$52<sup>95</sup>**



## B103

### 3 Piece Internal and External Retaining Ring Plier Set with Replaceable Tips

- Contains: B100, B101, B104
- In custom molded plastic case

List \$71.30

**\$38<sup>95</sup>**



### Body Hammer - Bumping

	Head Diameter	Overall Length	Head Length	List	
PH26	1 5/8"	12"	4"	\$64.55	<b>\$41<sup>95</sup></b>



### Tinnerns Hammer

	Head Weight	Overall Length	List	
17A	16oz.	13"	\$73.88	<b>\$42<sup>95</sup></b>



### Soft Face Hammers

• Up to 200% stronger than previous design.

	Head Diameter	Overall Weight	Tip Length	List	
PH15	1 7/32"	8 oz.	1"	\$41.82	<b>\$26<sup>95</sup></b>
PH20	1 11/32"	16 oz.	1"	\$59.71	<b>\$38<sup>95</sup></b>



### Ball Pein Hammer Magna-flux Tested

	Head Weight	Length	List	
212	48 oz.	16 1/2"	\$74.10	<b>\$42<sup>95</sup></b>
212A	40 oz.	16 1/2"	\$63.83	<b>\$36<sup>95</sup></b>
212C	32 oz.	15 3/4"	\$58.32	<b>\$33<sup>95</sup></b>
212E	24 oz.	15 3/4"	\$53.19	<b>\$29<sup>95</sup></b>
212G	16 oz.	13 3/4"	\$43.25	<b>\$24<sup>95</sup></b>



91425A

### Scratch Awl

- 4" long blade
- 7 3/4" overall length

List \$15.92

**\$9<sup>95</sup>**



92460

### Pocket Screwdriver with Clip

- 3" long blade
- 5 1/2" overall length

List \$4.49

**\$2<sup>95</sup>**



86980

### 8 Piece Precision Screwdriver Set

- Phillips® No. 00, 0, 1
- Slotted 2, 2.5, 3, 3.5, 4 mm

List \$71.14

**\$37<sup>95</sup>**



86009

### 9 Piece Heavy Duty Comfort Grip Screwdriver Set

- Slotted 8 1/4", 10 1/4", 11 1/4", 12 1/4" long
- Phillips® No. 1 7 1/4" long, No. 2 8 1/4" long, No. 3 10 5/8" long
- Square Recess No. 1 & 2 8 1/4" long
- Full length blade with hex bolster goes through handle to end cap.
- Tip style etched on end cap.

List \$126.14

**\$64<sup>95</sup>**



86029

### 32 Piece Gearless Screwdriver Set

- Contains:
 

Slotted #: 3, 4, 5, 6 & 7	Square Recess #: 1, 2 & 3
Phillips® #: 0, 1, 2 & 3	Pozidriv® #: 1, 2 & 3
Hex #: 2, 2.5, 3, 4 & 5	2.5" Bit holder
Torx® #: 8, 9, 10, 15, 20, 25, 27, 30, 40	

• Includes storage case

List \$47.70

**\$27<sup>95</sup>**

# Want to be sure you never miss a promotion or special offer?

Two convenient ways to stay updated: receive a hard copy version of the flyer in your mailbox, or e-mails directly to your desktop or mobile device. To sign up simply visit [www.graytools.com/specialoffers](http://www.graytools.com/specialoffers) and complete the form for the option that works best for you. It's that easy.



## Digital Caliper - Metal Housing

	Range	List	
DC6150	0 - 6" / 0 - 150mm	\$92.51	<b>\$59<sup>95</sup></b>
DC8200	0 - 8" / 0 - 200mm	\$134.20	<b>\$86<sup>95</sup></b>



92125M

## 25 Piece Metric Colbalt Steel Drill Bit Set

- 1 - 13mm
- Jobber length
- 135° split point
- Grade: M35 Steel Spec.
- DIN1412-ANSI Standard N
- Includes plastic storage case

List \$269.67

**\$173<sup>95</sup>**



## Tube Bender - Single Head

	Tube O.D.	Overall Length	List	
TB108	1/4"	11 1/2"	\$33.23	<b>\$21<sup>95</sup></b>
TB110	5/16"	12 1/2"	\$37.04	<b>\$23<sup>95</sup></b>
TB112	3/8"	13 1/2"	\$44.45	<b>\$28<sup>95</sup></b>
TB116	1/2"	17 1/2"	\$59.27	<b>\$38<sup>95</sup></b>
TB120	5/8"	18 1/2"	\$74.08	<b>\$47<sup>95</sup></b>

- 180° bending capacity.



WSB60

## 60" Wrecking Bar

- Hardened leverage end
- Nickel plated finish
- 1" Shank size

List \$147.54

**\$99<sup>95</sup>**



Swivel Head

## L-Clamps

	Capacity	Proof Test (lbs)	List	
L408	0-8"	2,645	\$69.10	<b>\$44<sup>95</sup></b>
L412	0-12"	2,645	\$82.47	<b>\$52<sup>95</sup></b>
L416	0-16"	2,645	\$92.40	<b>\$59<sup>95</sup></b>
L420	0-20"	2,645	\$110.75	<b>\$71<sup>95</sup></b>



## Erectors - Pry Bars

	Length	List	
73324	24"	\$59.43	<b>\$38<sup>95</sup></b>
73330	30"	\$66.29	<b>\$42<sup>95</sup></b>
73336	36"	\$82.29	<b>\$52<sup>95</sup></b>
73348	48"	\$91.44	<b>\$58<sup>95</sup></b>

- 7/8" Hexagon shank
- Blue paint finish